

PRELIMINARY

KS21 SUBWOOFER



- High power compact 21" subwoofer
- Exceptional impact
- Improved efficiency
- Lightweight (49 kg / 108 lbs)
- Simple, fast, integral rigging
- Supported by LA4X and LA12X



ELECTRO-ACOUSTICS



KS21 is a compact reference subwoofer designed to extend the bandwidth of A15 and A10 systems. KS21 features one high excursion, direct radiating 21" transducer mounted in a bass-reflex tuned enclosure.

KS21 operates from 29 Hz to 60 Hz when associated with A15 or 30 Hz to 100 Hz when associated with A10. KS21 features L-Vents that substantially reduce turbulence and port noise at high levels while also increasing LF efficiency.

The KS21 frequency response is optimized to couple perfectly with both systems. KS21 features a two-point, integrated rigging system that is compatible with A15. Combinations of KS21 and A15 can be flown or stacked to form a full range line source. KS21 also integrates a threaded insert to enable pole-mount configurations of A15 or A10.

KS21 can be deployed in standard or cardioid configurations with dedicated presets, for flown and stacked deployment.



L-Vents laminar vented ports

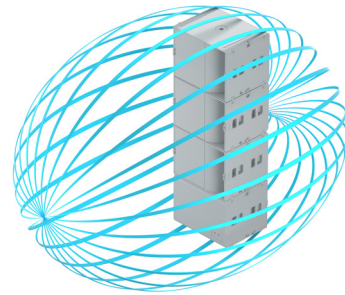

Rear SPL rejection (cardioid)

PHYSICAL

The KS21 enclosure is constructed of premium grade Baltic beech and birch plywood to ensure maximum acoustical and mechanical integrity. Bent wood technology combined with a thickness optimization process maximizes internal volume while attaining the low weight of 49 kg / 108 lb. The lightweight and robust design facilitates deployment and on-the-road manipulation.

KS21 integrates a patent pending two-point, captive rigging system that simplifies deployment and provides visual safety assessment. KS21 features ergonomic handles to ensure efficient handling, bottom ground runners and matching top tracks to secure stacking deployment and corner stops to protect side panels.

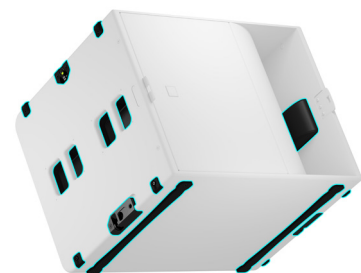

Integrated rigging with safety check; ergonomic handles; ground runners; corner stops.

APPLICATIONS AND BENEFITS

KS21 is the ideal companion for small to large events that require bandwidth extension and strong impact in a compact enclosure. KS21 is acoustically compatible with A15 and A10 and therefore is particularly suited to reinforce the low frequency contour of both systems.

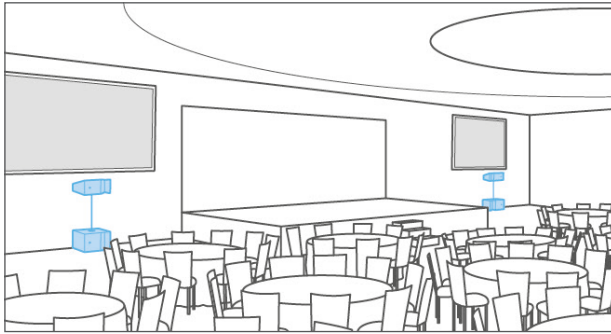



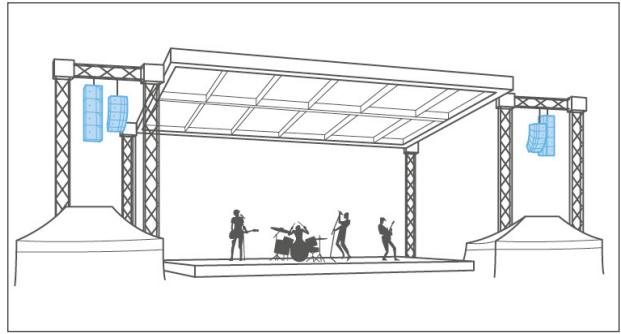

Corporate main system

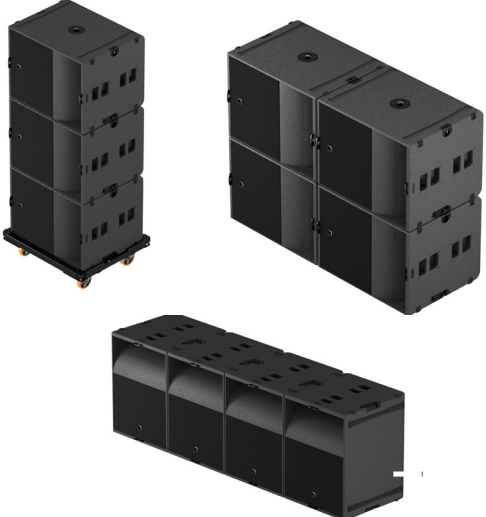

Green field main system

RIGGING

KS21 can be groundstacked horizontally or stacked vertically on a KS21-CHARIOT. A15-BUMP supports flown vertical arrays in standard or cardioid arrangements. KS21 integrates a secure and easy-to-use rigging system that is compatible with A15 to facilitate any combination of flown or stacked deployment.

 <p>Groundstacked / KS21-CHARIOT Up to 3 KS21 per KS21-CHARIOT</p> 	 <p>A15-BUMP Up to 16 KS21</p> 	 <p>A15-RIGBAR Up to 4 KS21</p> 
---	--	--

TRANSPORTATION ACCESSORIES

<p>KS21-COV protective cover for 1 KS21</p> 	<p>KS21-PLA removable front dolly for 1 KS21</p> 	<p>KS21-CHARIOTCOV protective cover for 3 or 2 KS21 on KS21-CHARIOT</p> 	<p>KS21-CHARIOT chariot for up to 3 KS21</p> 
--	---	--	---

AMPLIFIED CONTROLLER

LA4X: amplified controller with DSP



4 x 1000 W / 8 ohms or 4 ohms
 4 inputs x 4 outputs architecture
 Max 4 enclosures per amplified controller

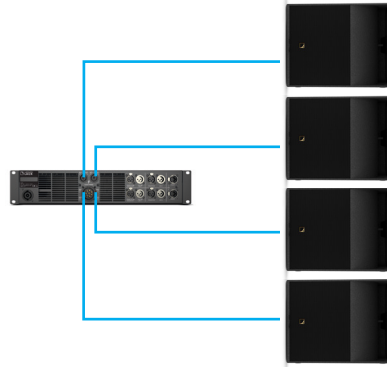

LA12X: amplified controller with DSP



4 x 2600 W / 4 ohms
 4 inputs x 4 outputs architecture
 Max 8 enclosures per amplified controller

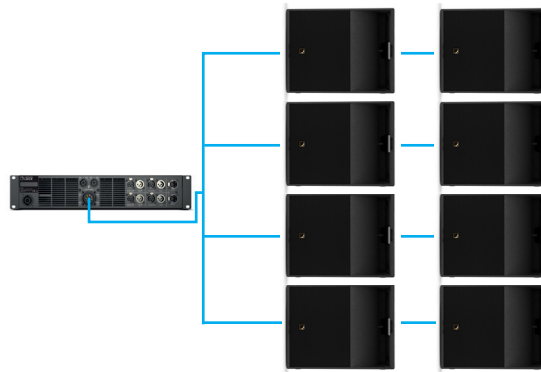

ASSOCIATED ENCLOSURES



A15 Focus



A15 Wide



A10 Focus



A10 Wide

SOFTWARE

SOUNDVISION: simulation software

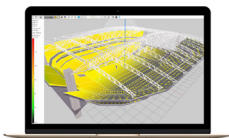

3D electro-acoustic & mechanical simulation software

LA Network Manager: control & monitoring software



Real-time control and monitoring up to 253 units
 Multiple network topologies



SB15m



SB18 (i/m)



KS21



K1-SB



SB28

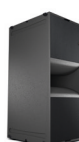

KS28

Subwoofers: a complete range for professional sound reinforcement

L-Acoustics subwoofers complement systems in applications where extended bandwidth is required.

All subs incorporate high excursion drivers, ultra-low vibration walls and laminar airflow L-Vents with a flared profile, resulting in dramatic reduction of port noise, maximized dynamics, power handling and an exceptional level of performance.

PRELIMINARY

KS21 SUBWOOFER



Description	High power compact subwoofer: 1 × 21" amplified by LA4X / LA8 / LA12X
Usable bandwidth (-10 dB)	31 Hz - 100 Hz ([KS21_100])
Maximum SPL¹	138 dB ([KS21_100])
Nominal directivity	Standard or cardioid configurations
Transducers	1 × 21" neodymium cone driver
Acoustical load	Bass-reflex, L-Vents
Nominal impedance	8 Ω
Connectors	IN: 1 × 4-point speakON LINK: 1 × 4-point speakON
Rigging and handling	Flush-fitting two-point rigging system 1 pole mount with M20 × 150 insert 4 handles, 8 corner stops and 2 ground runners
Weight (net)	49 kg / 108 lb
Cabinet	Premium grade Baltic beech and birch plywood
Front	Coated steel grill Acoustically neutral 3D fabric
Rigging components	High grade steel with anti-corrosion coating
Finish	Dark grey brown Pantone 426 C



¹ Peak level at 1 m under half space conditions using pink noise with crest factor 4 (preset specified in brackets).

ISOCONTOUR

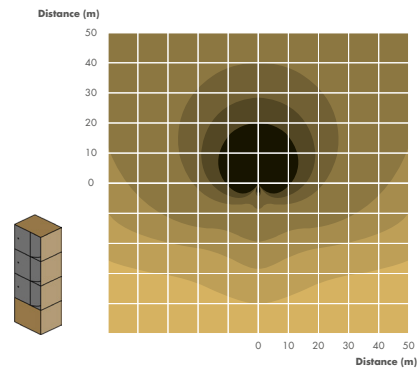
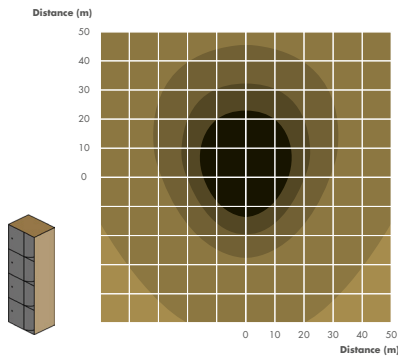

► SPL mapping of a block of four KS21 in standard (left) and cardioid (right) arrangements, using surfaces of equal sound pressure with three dB step colored scale.

DIMENSIONS

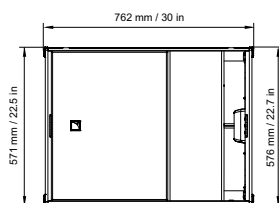

Front

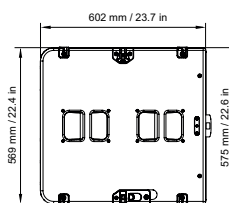

Side

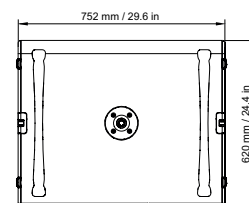

Top